



CARY GROVE PARK

Aquatic Center

28 May 2020

Presented by:



CARY PARK DISTRICT

Introduction

Updated Cary Grove Park Master Plan

Conceptual Aquatic Center Plan

Features / Amenities

Agenda

2

In September 2019, the Cary Park District Board of Commissioners took action to move forward with the planning, development, and construction of an outdoor aquatic facility at Cary-Grove Park to replace the Community Center pool that is over 40 years old. A replacement for the current pool was a top desire expressed by the community and the Board of Commissioners as a result of the 2016 Comprehensive Master Plan Update development. Planning for the project has been ongoing since that time and preceded events related to COVID-19.

The new outdoor aquatic facility is a community infrastructure project that will have a long life span, likely to equal the 40 years of the current pool. Benefits to the community will include improved quality of life to be gained from the availability of high quality recreation facilities, further connectivity and expansion of the multi-use trail system, positive impacts on home and resale values, as well as, job creation particularly in the age segments of high school and college age students.

Additional benefits to those who use the outdoor aquatic facility will include program options and amenities that will appeal to all age groups from toddlers to seniors, improved health and fitness, increased capacity and space to enjoy the facility, and thoughtful improvements to shade and seating options. Participation in the virtual open house will illustrate these items through the use of examples and pictures of the various features.

Introduction

3

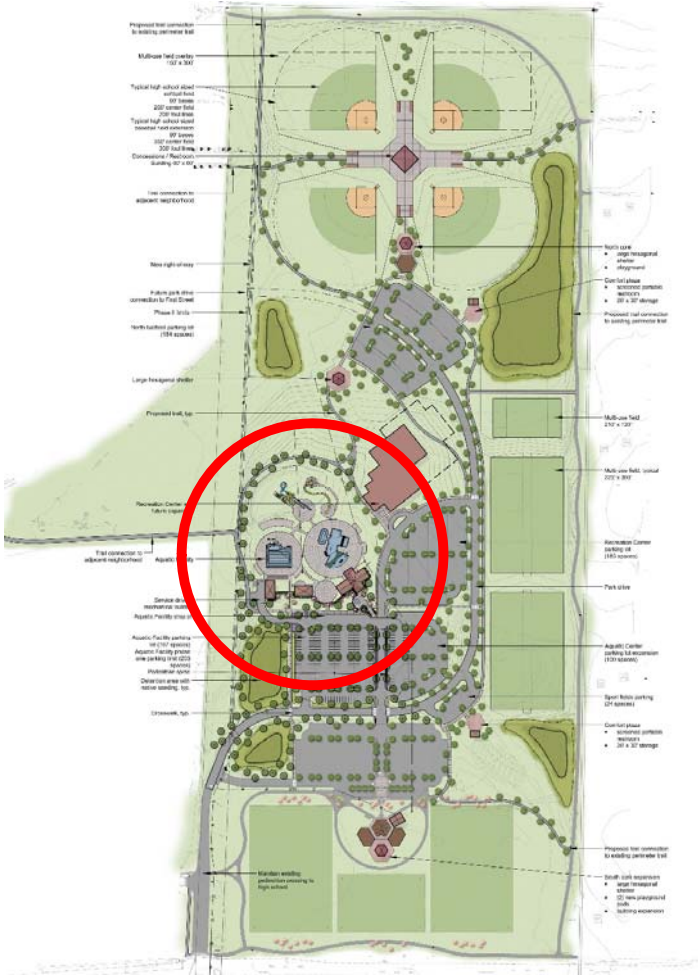

Expansion of Cary Grove Park, including the following amenities:

- Expanded Parking
- Roadway
- Aquatic Center
- Recreation Center
- Athletic Play Field

The current planning includes a new Aquatic Center with associated parking and roadway.

Updated Cary Grove Park Master Plan

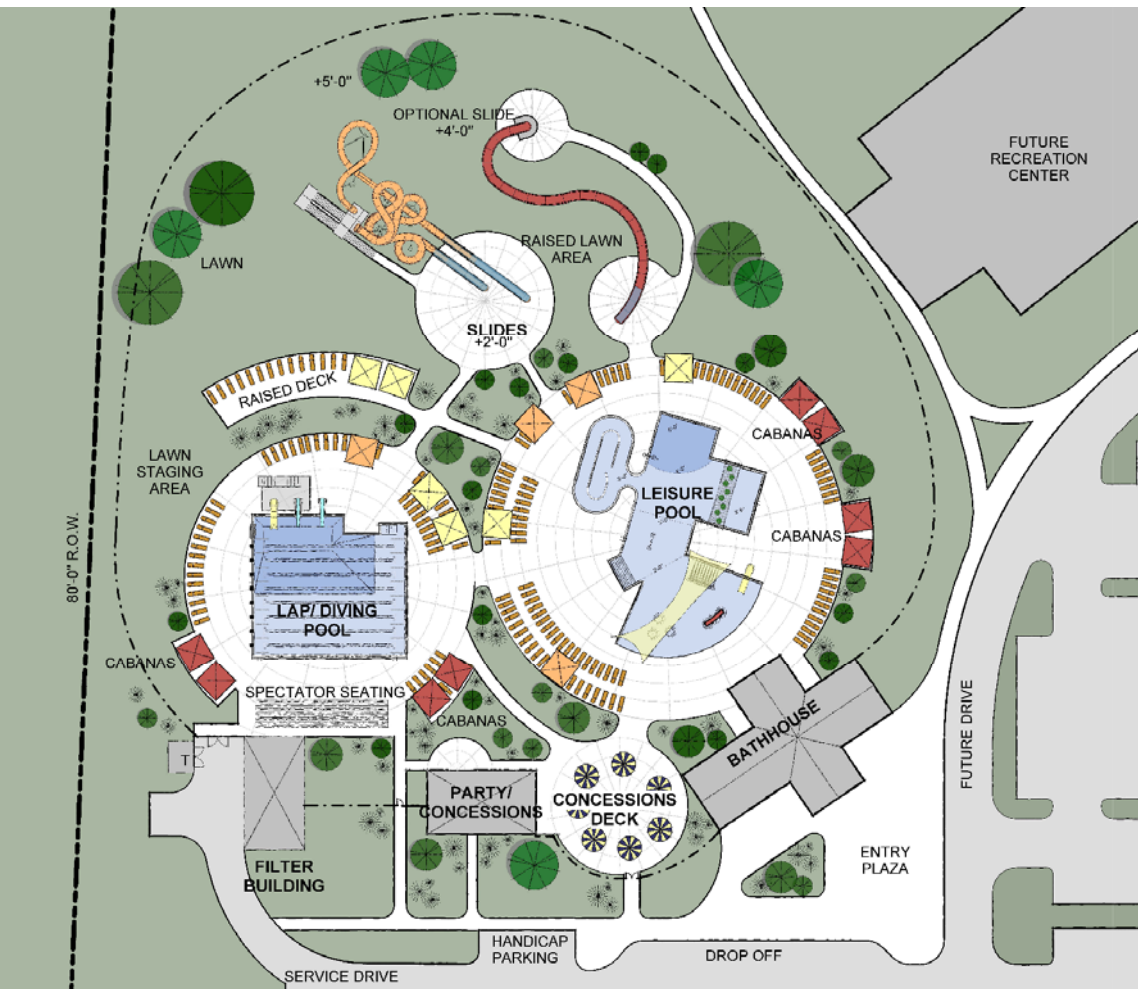

The Cary Park District Board has approved to proceed with the Cary Grove Park Aquatic Center as the initial phase of the overall Cary Grove Park Master Plan implementation.

The plan consists of two bodies of water, one being a Leisure Pool and the other a Lap / Competition Pool and other related amenities.

The following slides will provide additional detail of the plan to your left.

Preliminary Aquatic Center Plan

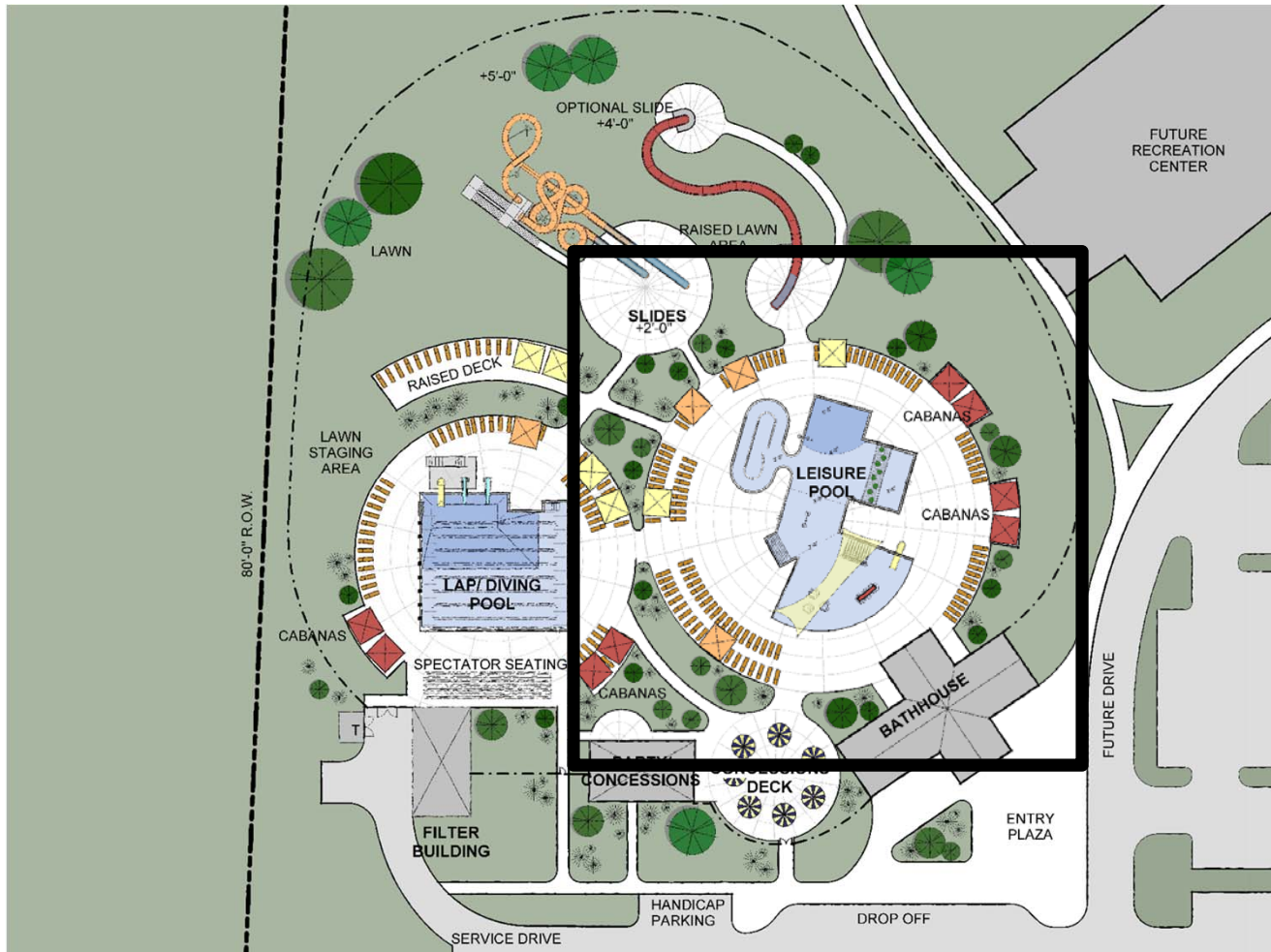

Leisure Pool

6

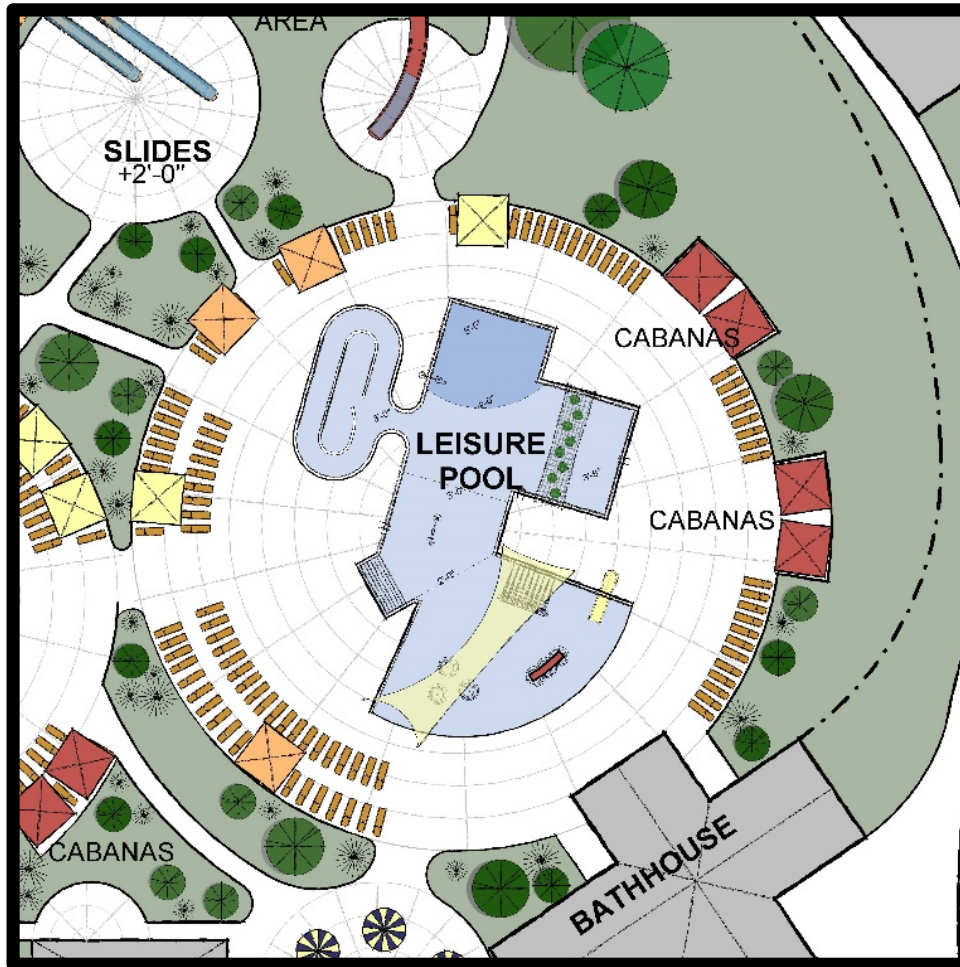

Leisure Pool

The Leisure Pool is approximately 6,000 SF in size. It is comprised of a zero-depth entry and gradually increases in depth up to 5 ft at the far end of the pool.

This pool provides a multitude of leisure, play and program opportunities.

It is surrounded with ample deck space to allow for easy circulation and plenty of lounge areas in sun and shade.

Leisure Pool

Zero Depth Entry



- Zero Depth Entry showing Bubblers, Jets and Shade over the water

Leisure Pool

Zero Depth Entry

9

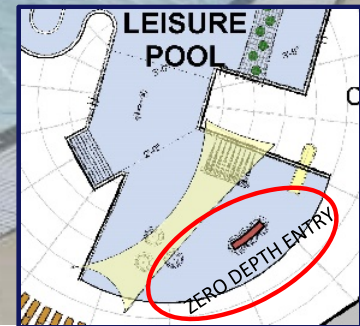

- **Zero Depth Entry Showing bubblers, sprays and example of a tot slide**

Leisure Pool

9

Tot Slide



- Other examples of tot slides

Leisure Pool

10

Deck Sprays

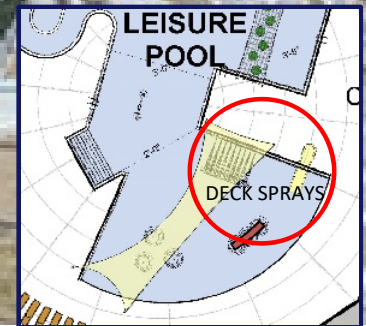

- Deck sprays

Leisure Pool

11

Bubblers

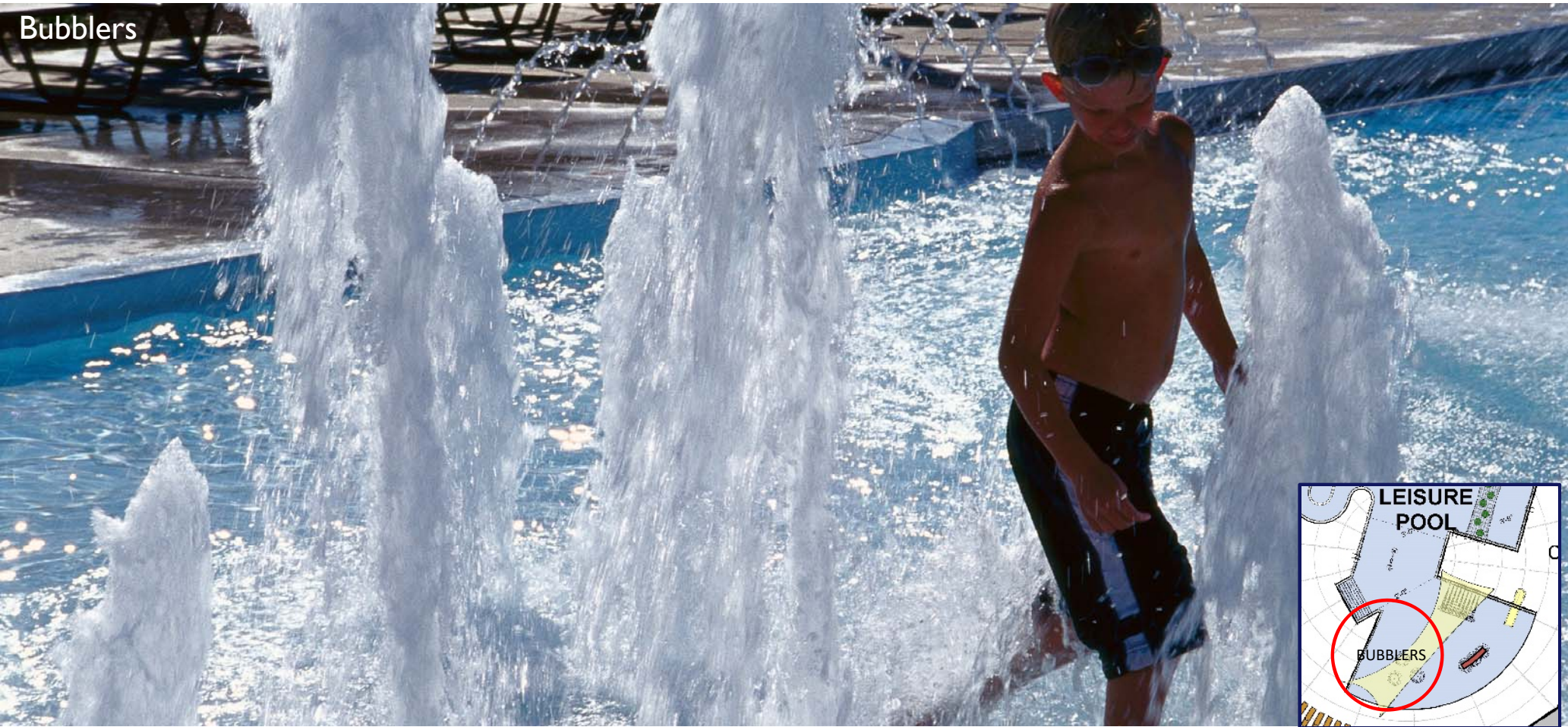

- Bubblers

Leisure Pool

12

Water Play



- Pools and falls play feature

Leisure Pool

13

Zero Depth



- The Leisure Pool will have a zero depth entry with shallow water that progressively gets deeper. It's great for just relaxing or playing with your small children in a very safe environment

Leisure Pool

14

Water Play



- The Leisure Pool will have multiple play features. This feature is in about 2 ft of water and generally is interactive (children can spin and/or control water flow.)

Leisure Pool

15

Step Entry / Benches



- Even with zero entry, steps are very popular. Many people with limited mobility prefer stairs. Steps also provide a great place for parents to sit and introduce their children to slightly deeper water.

Leisure Pool

16

Current Channel



- This feature has a moving current that is fun for swimmers and can also be used for resistive exercise.
- The center is a seating area with bubblers and jets which are great for relaxing and socializing.

Leisure Pool

17

Lily Pad Walk



- The pool will have a lily pad walk. The pads float, challenging children to navigate from one side to the other. These are very popular features and have the ability to be removed in the event the pool is being used for other programs

Leisure Pool

18

Water Programming

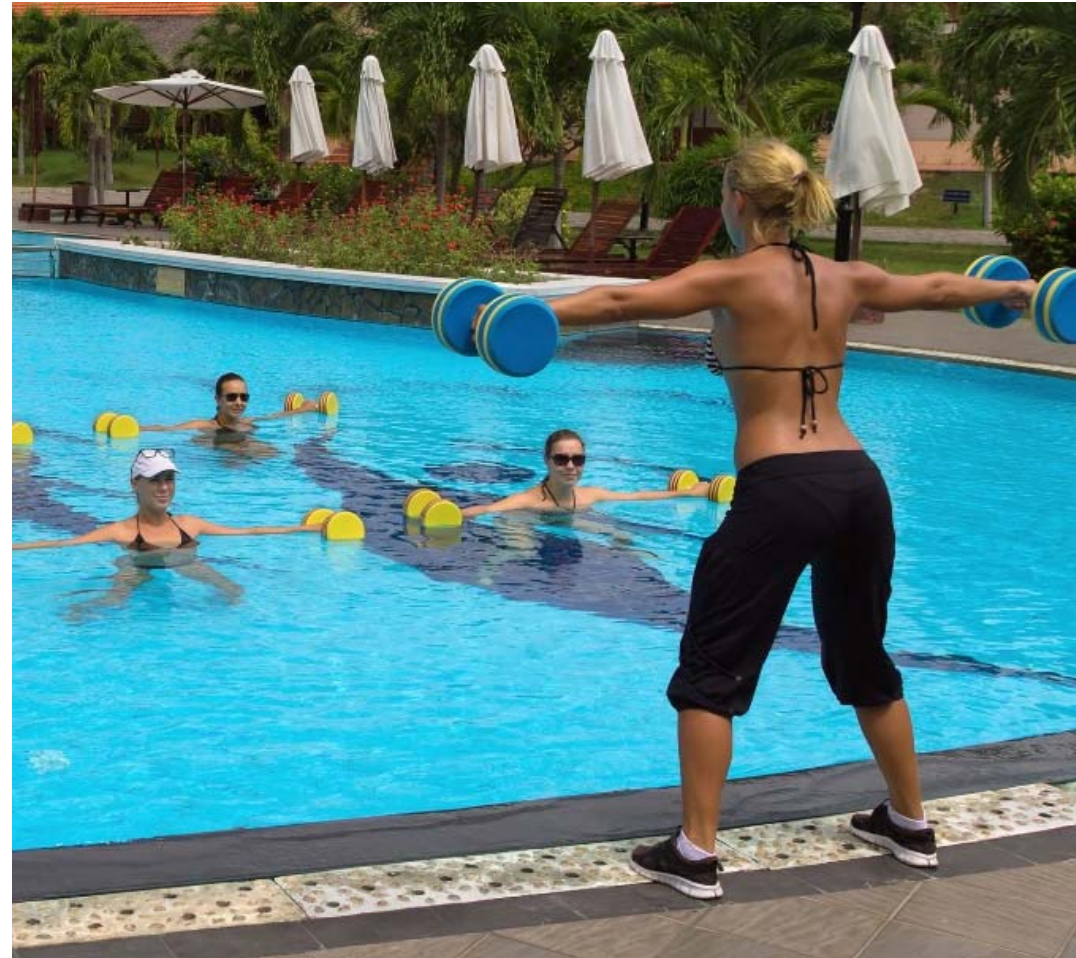

- The leisure pool gets gradually deeper until it reaches a maximum depth of 5 feet. The varying depths allow for a multitude of activities and programming for all age groups.

Leisure Pool

19

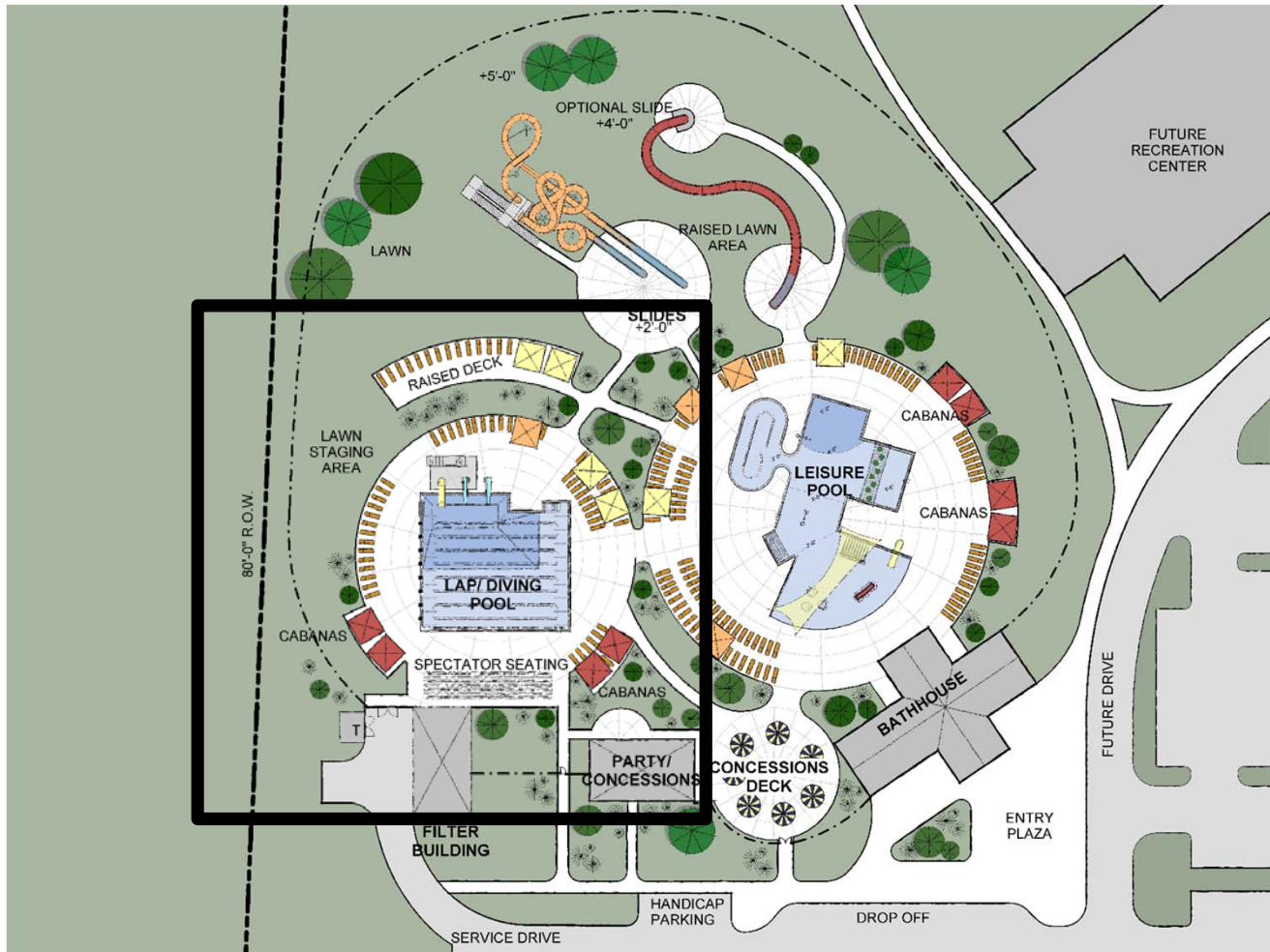

Lap Pool

20

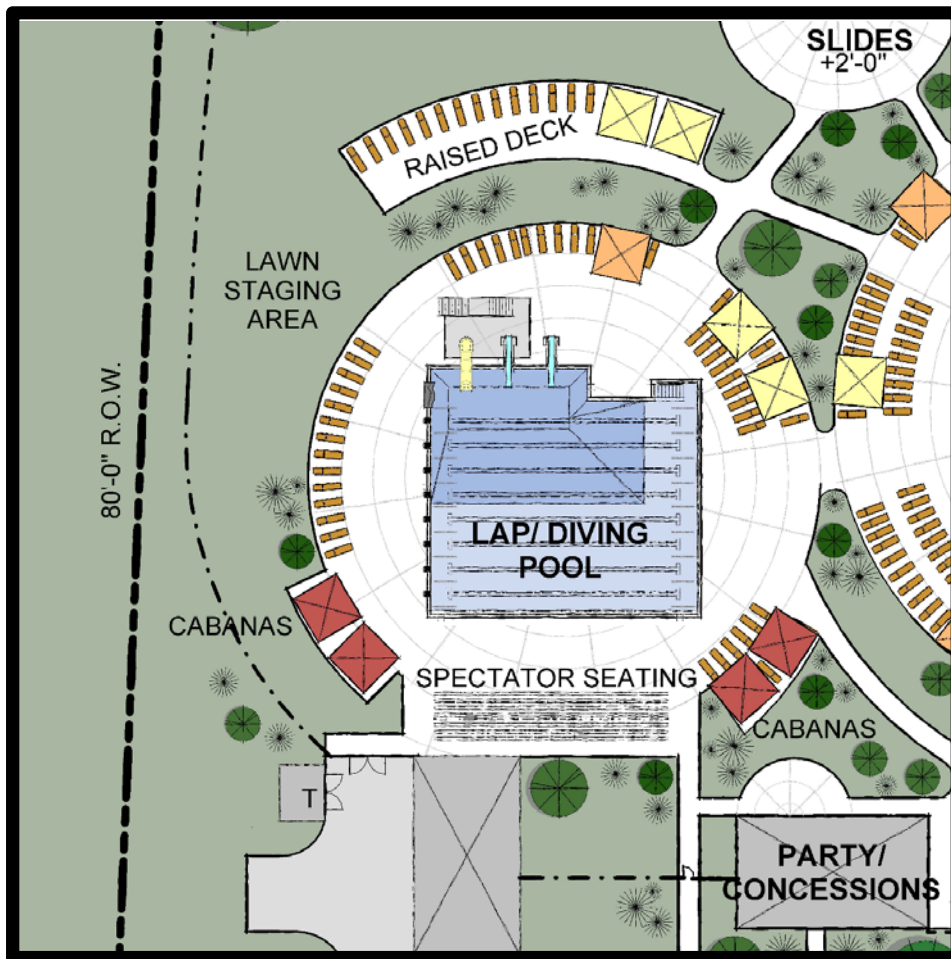

Lap Pool

The lap pool is designed for competitive swim and will be used by the local swim team, the Barracudas, for practice and swim meets.

The pool consists of 8 - 25 yard lanes. The dark blue represents deep water (over 12 ft) to allow for diving. The deep water is bumped out so 3 or 4 lap lanes are always available when the deep water is being used.

There is a platform that includes a 3-meter diving board and a drop slide. In addition, there is a 1-meter board and a climbing wall in this pool.

Lap Pool

Lap Swim

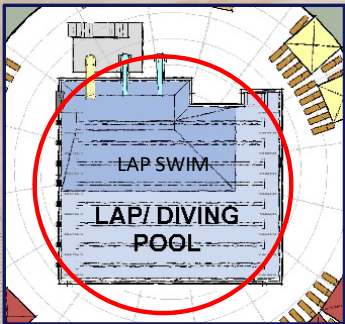

- This pool has similar characteristics to what is being planned for your facility. At the far end of the pool you can see the platform with the 3-meter board and the drop slide.

Lap Pool

22

Slides / Diving

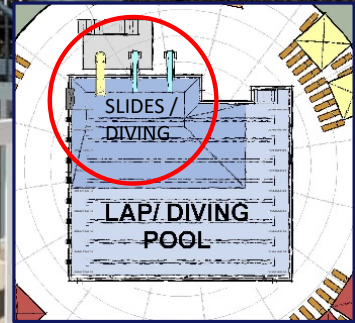

- This is a close-up view of the drop slide and the 3-meter diving board. The 1-meter board is in the background.

Lap Pool

23

Slides / Diving

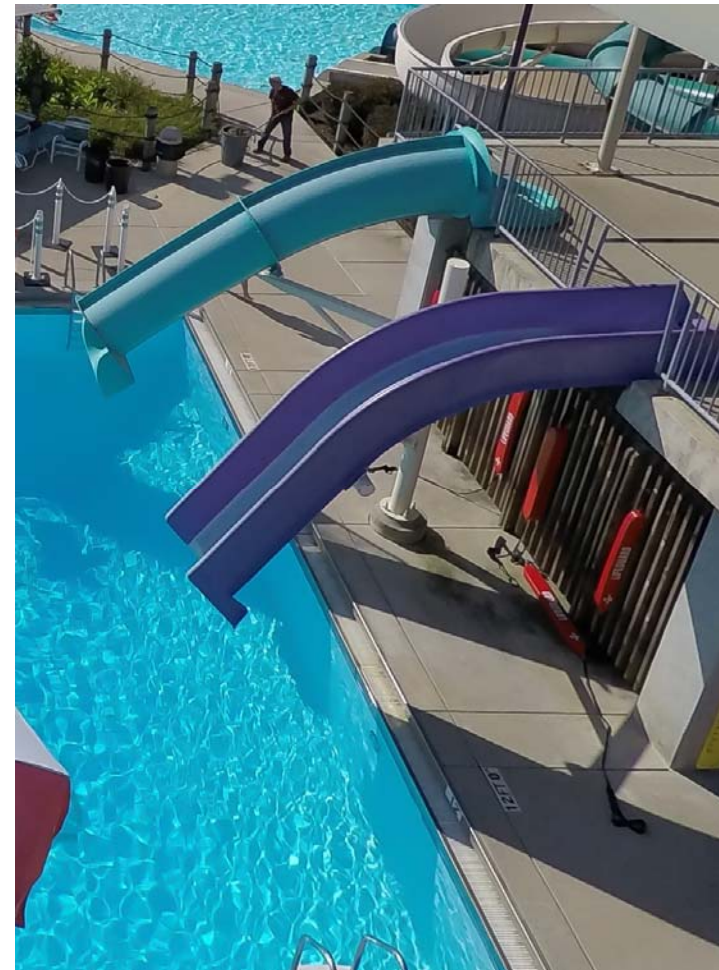

- The climbing wall is in "overlapping water" with the drop slide. When in operation, each feature can be used at different times during the day. This maximizes the use of deep water, which is the most expensive water in the facility.

Lap Pool

24

Slides / Diving

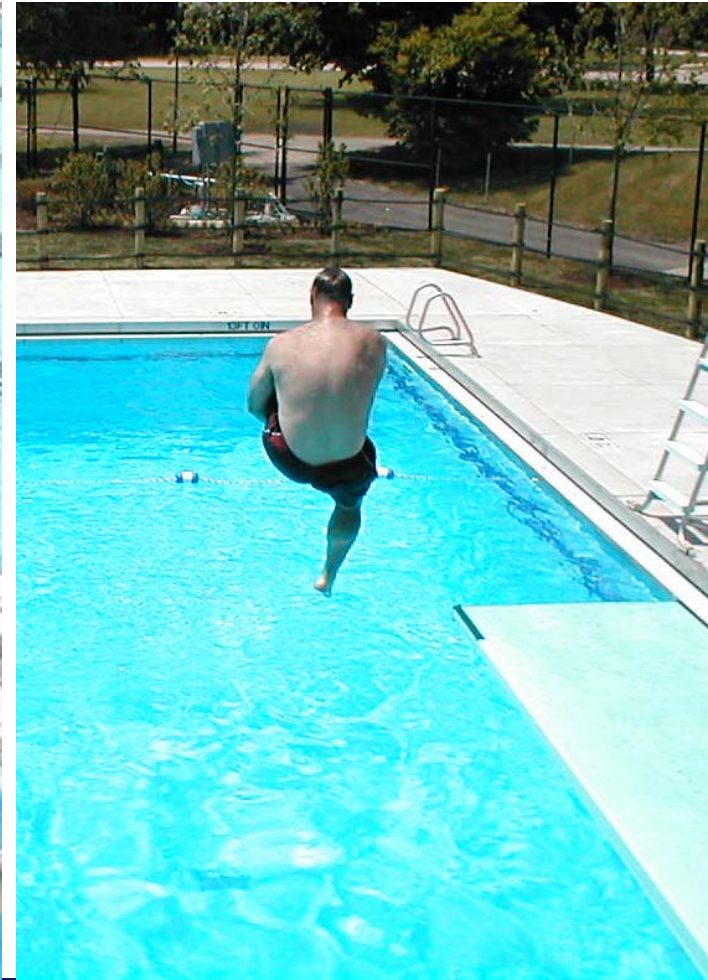

- Diving boards are always a very popular amenity.

Lap Pool

25

Scuba Lessons



- Having deep water allows for a variety of programming and exercise.

Lap Pool

26

Lap Swim



- Swim Team practice

Lap Pool

27

Competitive Swim



- Swim meets

Lap Pool

28

Spectator Seating



- Deck space is allocated for spectator seating for swim meets.

Lap Pools

29



- In addition to providing lifts, stairs are included at both pools. Stairs are often preferred by the elderly and individuals with limited abilities.

Lap Pool

30

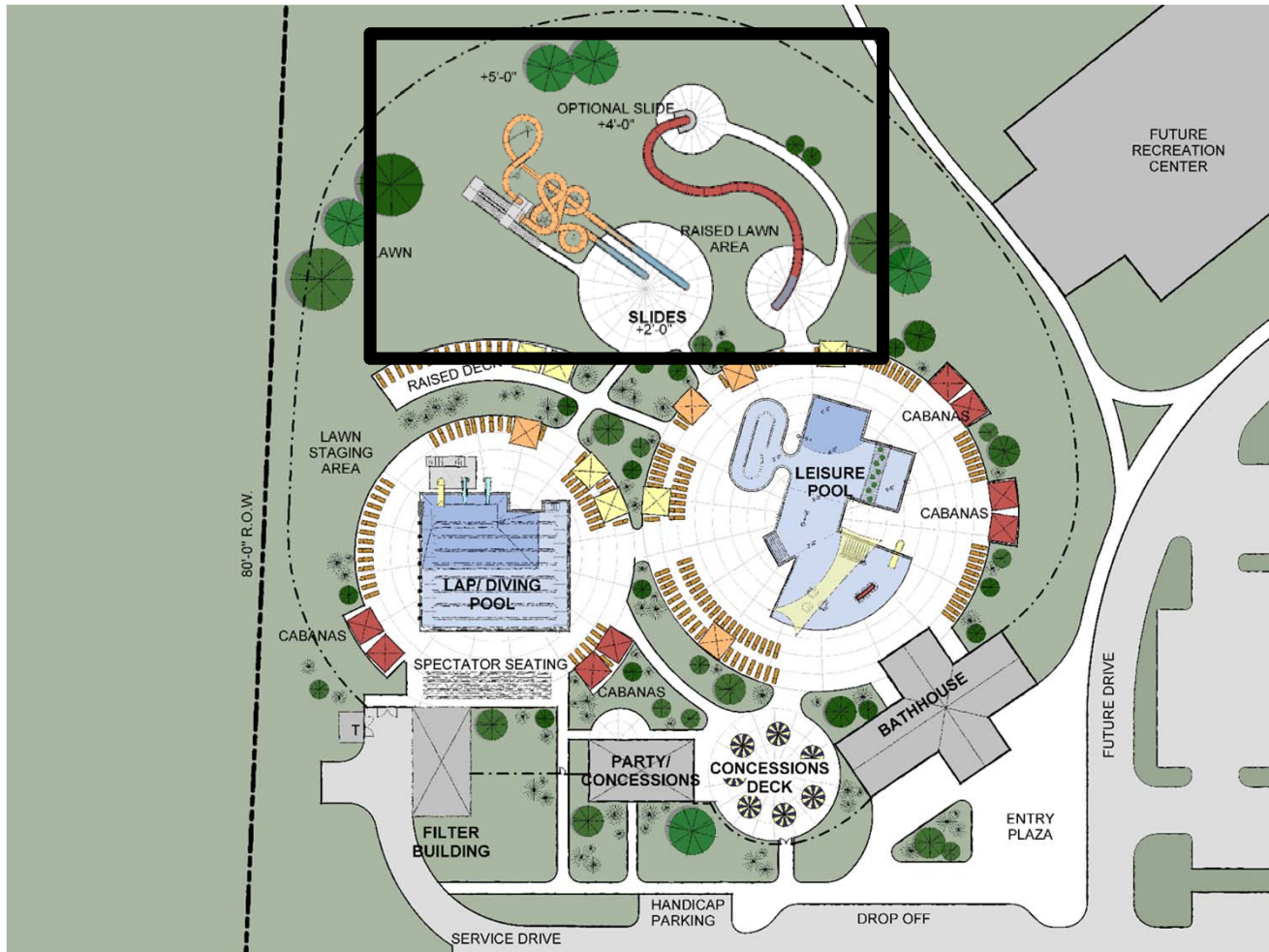

- Water slides are always a popular feature.

Water Slides

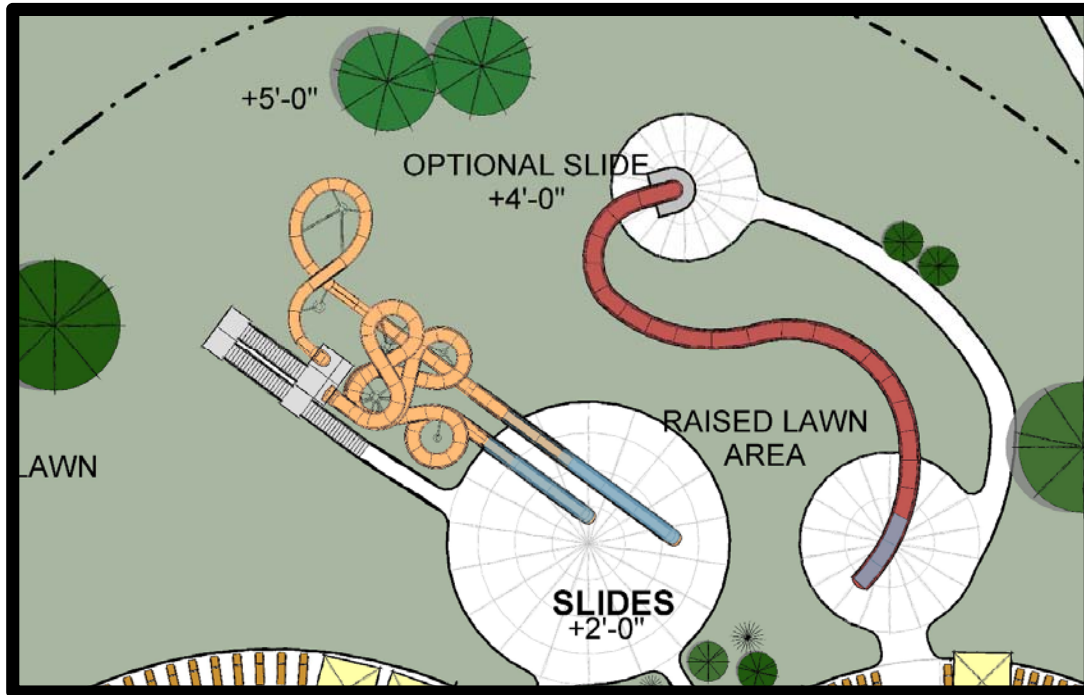

Water Slides

Two larger water slides are proposed. Slides are designed to offer multiple experiences, from open to closed to fast and curvy.

The plan also shows a smaller, accessible flume slide for smaller children. This slide is listed as optional, depending on budget constraints.

Water Slides

Run-Out Slides

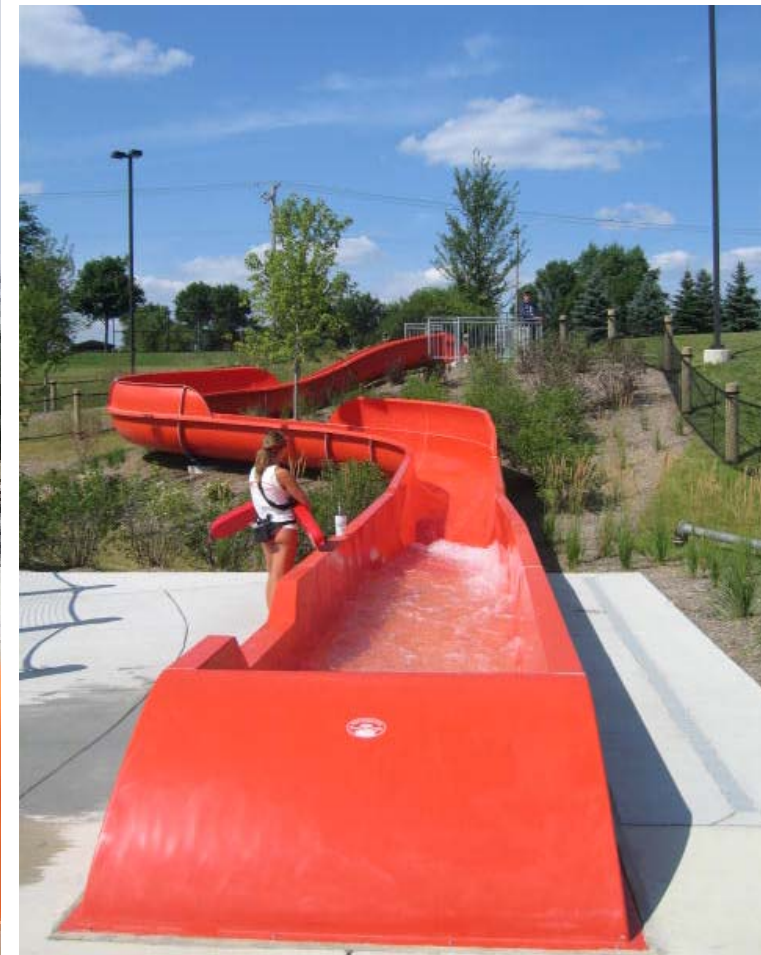
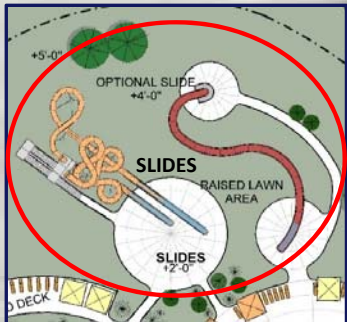

- Examples of water slides with a “run out trough”.

Water Slides

33

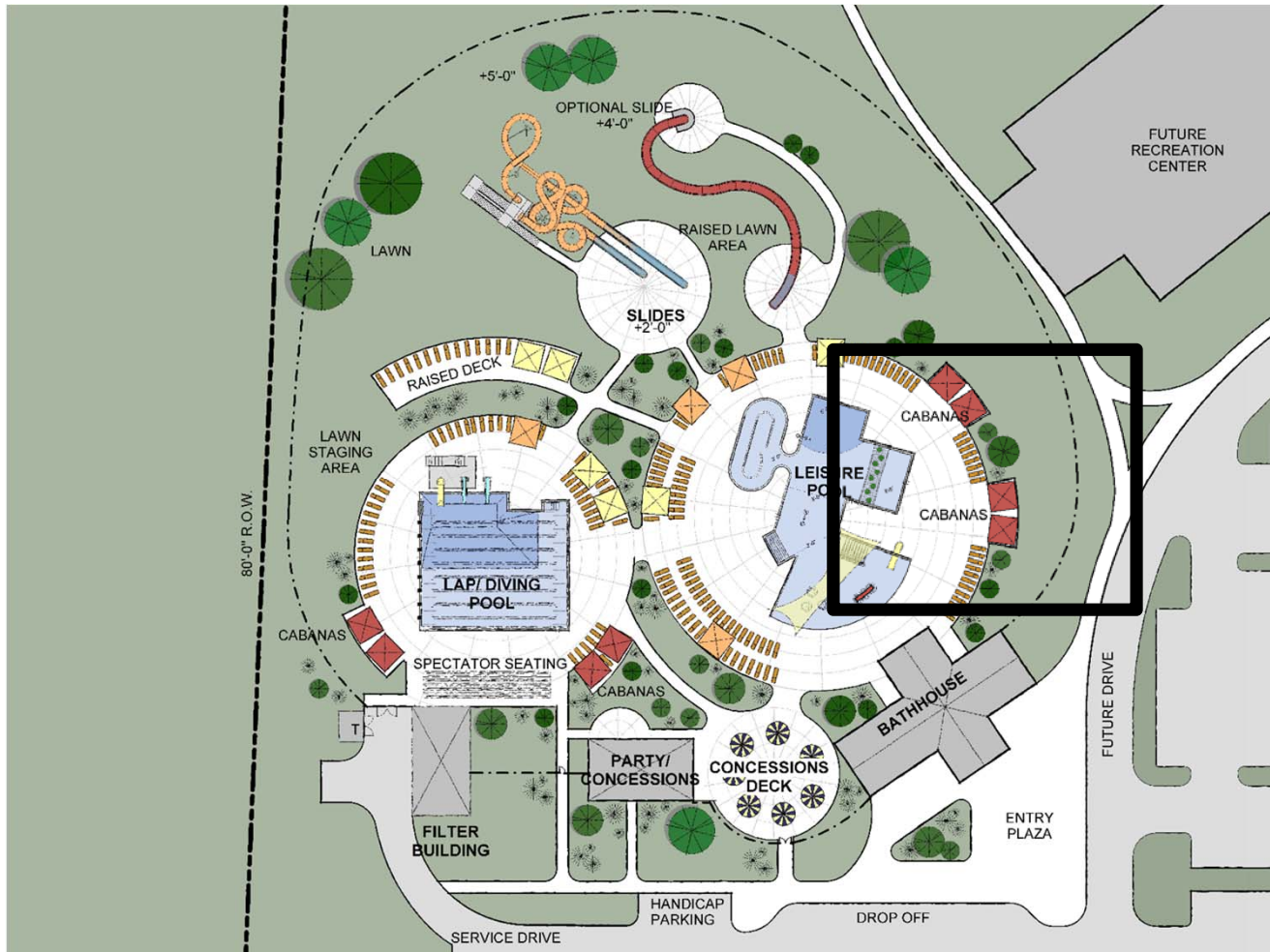

Cabanas

34

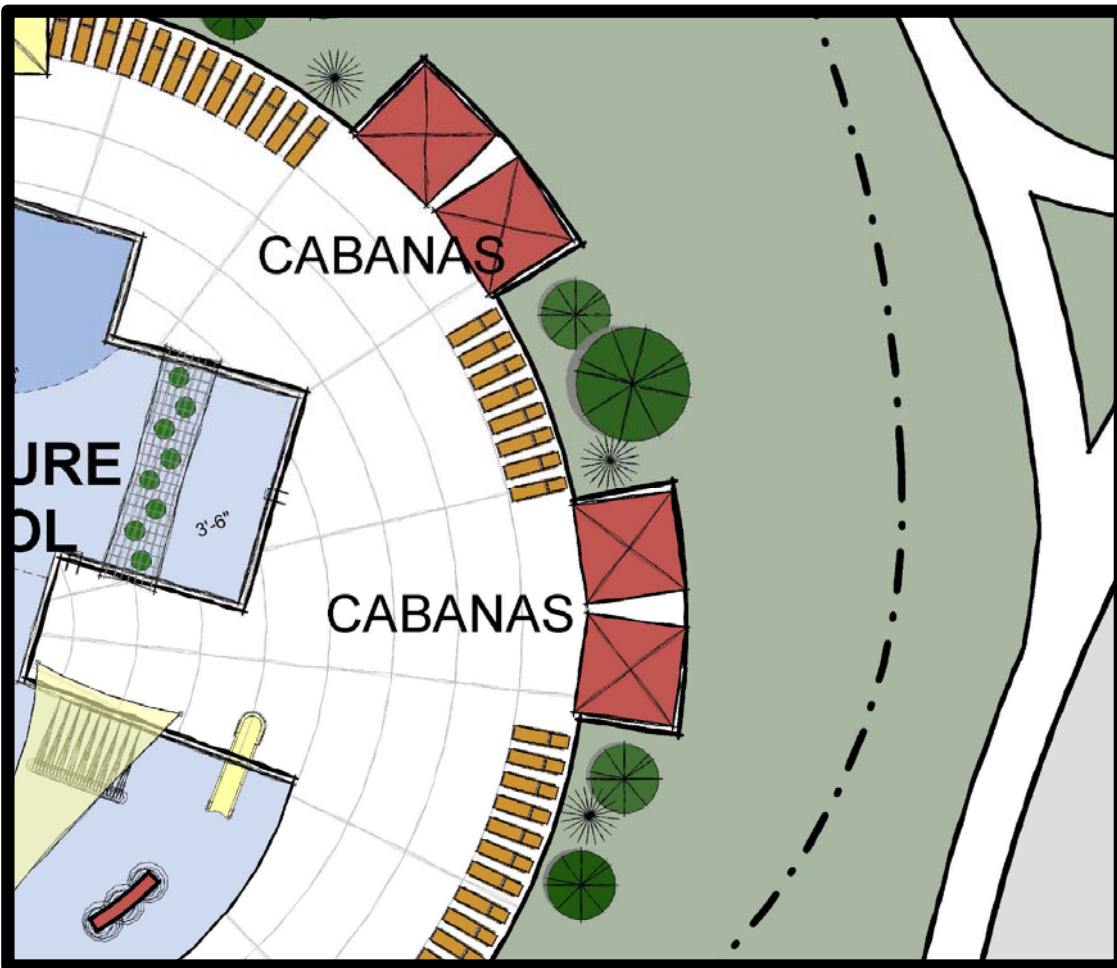

Cabanas

More and more facilities include multiple opportunities to get out of the sun.

Cabanas will be provided for groups to rent throughout the day.

Cabanas

35

Family Cabanas / Shade



Cabanas

36

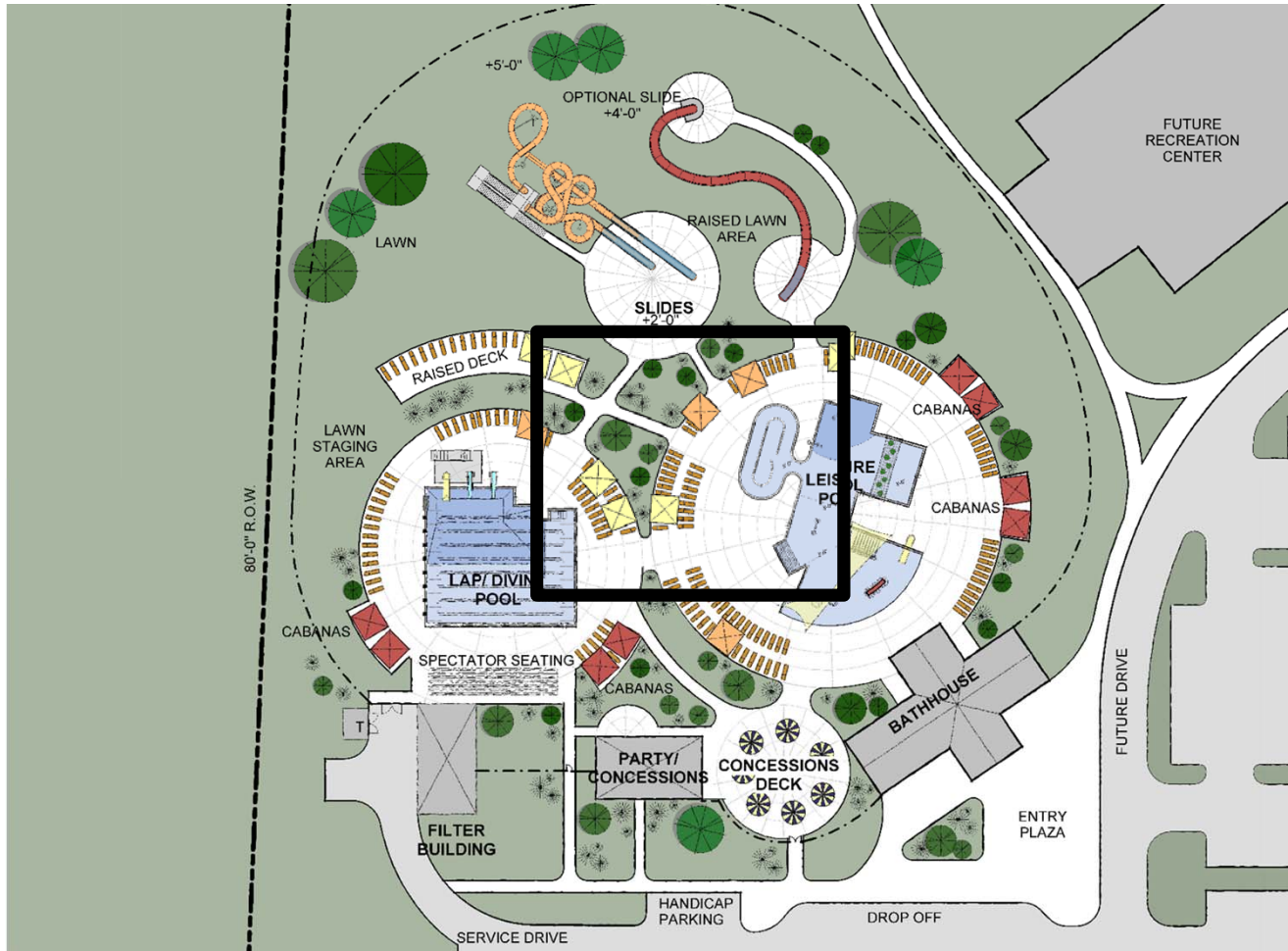

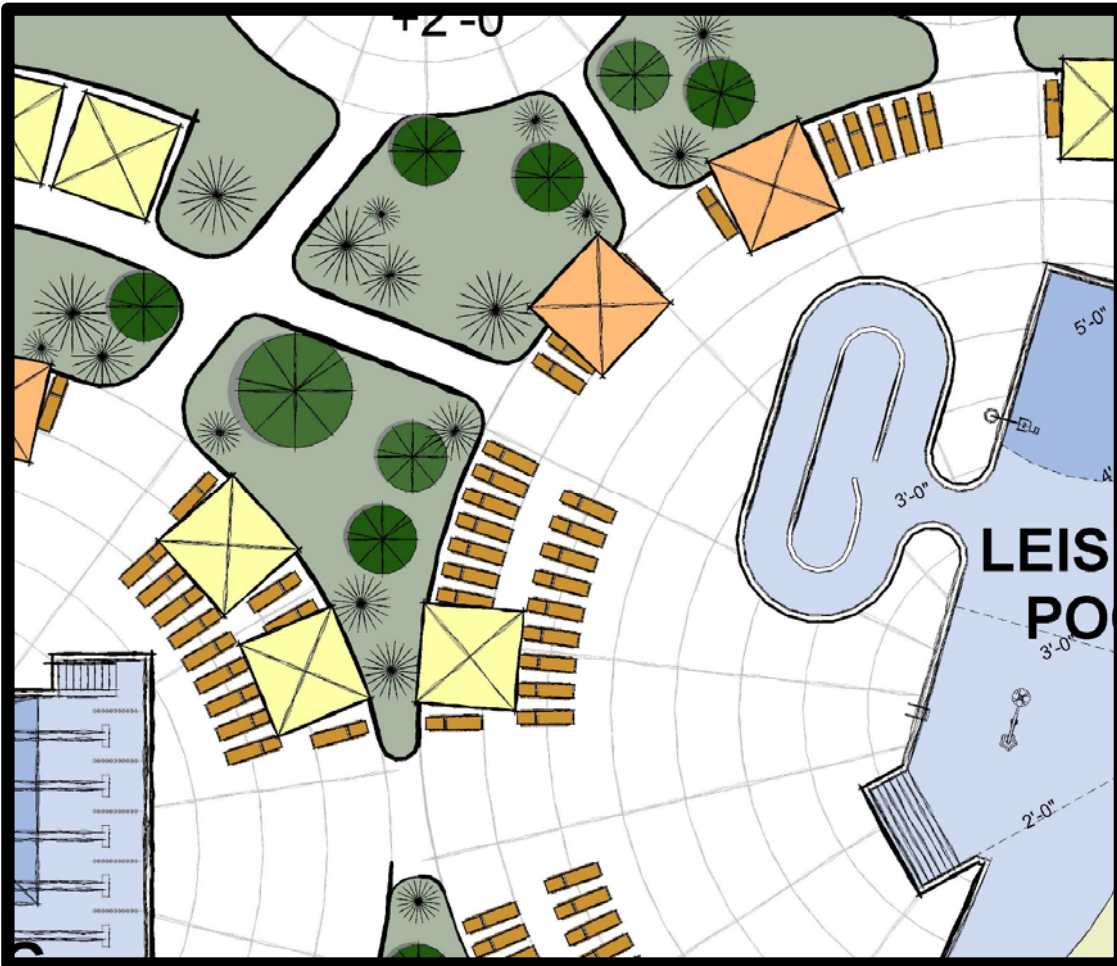

Shade

More and more facilities include multiple opportunities to get out of the sun.

This plan includes shade structure over the water, on decks, and in lawn areas.

Shade

38

Shade



Shade

39

Shade



Shade
40

Information presented in the design development phase in May 2020. Features are conceptual but representative of final selections of the project.



- Lawn is popular for additional lounge space, staging for summer camps, and bullpens for swim meets.

Lawn

41

Lawn



Lawn
42

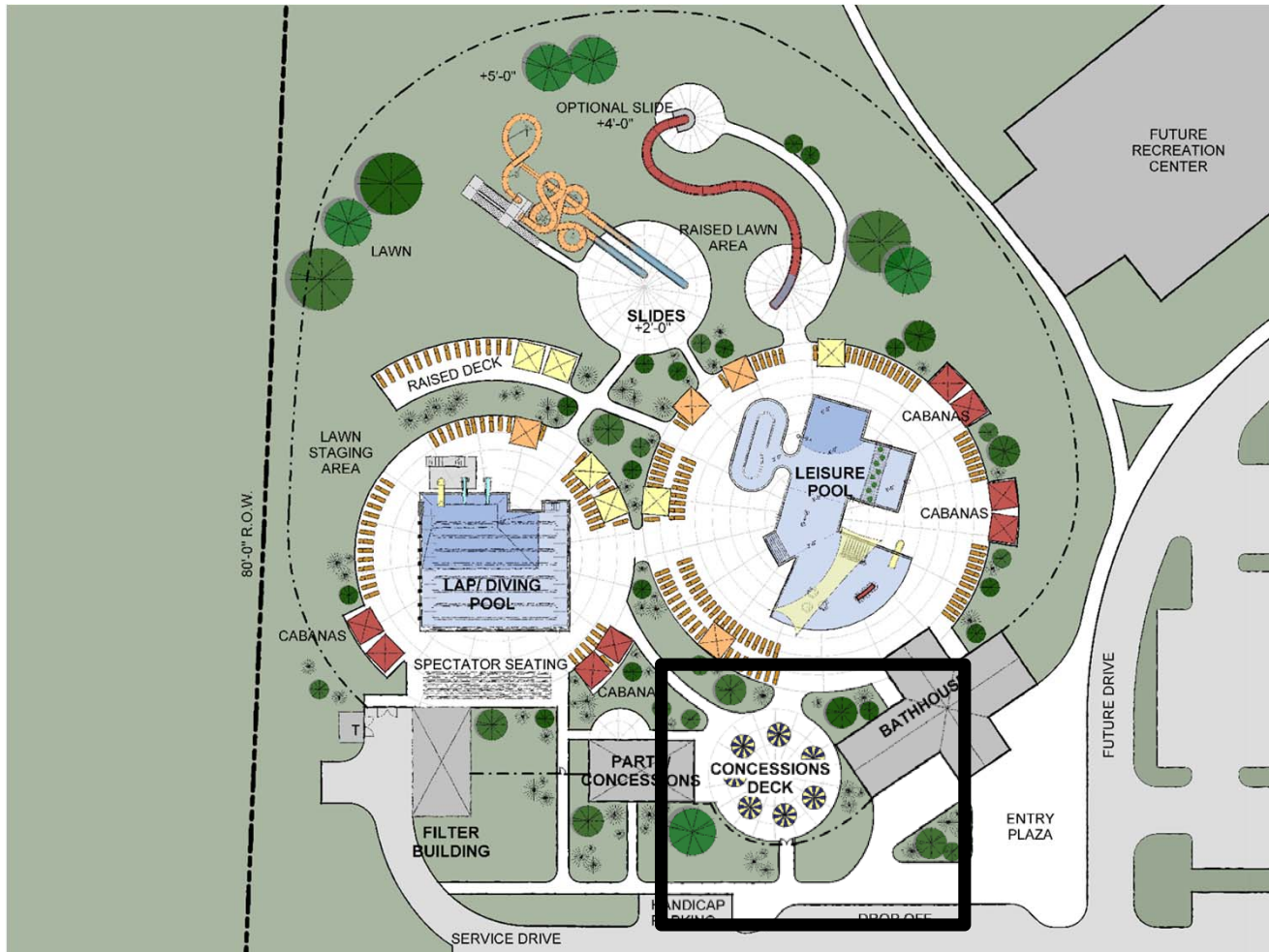

Concessions Deck

43

Concessions



- Concessions are a nice complement for an Outdoor Pool.

Concession Deck

44



Party Room / Deck

45

Party Room



- During the swim season, this room is available for birthday parties and group rentals. The room is also available throughout the balance of the year for programming and other activities.

Party Room / Deck

46

Party Room



Party Room / Deck

47

Information presented in the design development phase in May 2020. Features are conceptual but representative of final selections of the project.



CARY PARK DISTRICT